



Walara Series 440W G4P

Built to perform. Backed to last.

🌙 Australian Made.

The G4P is the ultimate evolution in Australian renewable energy industry manufacturing. Designed and engineered by a local and experience team based in South Australia.

🌙 16BB High Efficiency Cells.

Powered by N-Type TOPCon technology intergrated into premium power class laser-cut 16 busbar bifacial cells for fully opitmised output, efficiency and durability.

🌙 Intelligent Ultra-Rigid Structure.

Flex minimising 35mm no cut-back frame designed to protect the cells from micro-cracking and deliver increased integrity and longevity throughout extreme weather conditions.

🌙 Zero Defect Manufacturing Process.

Our unique process guarantees that every Tindo panel undergoes rigorous testing at 7 quality checkpoints ensuring high performance for the lifetime of the product.

🌙 Red Centre Resilience and Durability.

Our panels are mounted and performing everyday at the DKA Alice Springs. Tindo panels are consistently one of the highest performing panels at the centre. – dkasolarcentre.com.au

🌙 Market Leading Warranty and Local Support.

Our local and experienced service, warranty and technical teams offer market leading, comprehensive support throughout the lifetime of your product.



Walara 440G4P

Mechanical Characteristics

Cells per Panel	108 Half Cells
Cell Type	TopCon N-Type Cells
Panel Dimension	1722 x 1133 x 35 mm
Panel Weight	21 Kg
Front Glass	3.2mm Fully tempered double ARC glass
Frame	Anodized aluminum alloy (T6) / Black
Junction Box	3 bypass diodes / IP68 rated
Cable	1200 mm(+/-), 4mm ²
Connector Type	Staubli-MC4 / KST4-EVO 2(M), KBT4-EVO 2(F)

Thermal Characteristics

RATING	UNIT	VALUE
Operating Temperature	°C	-40 ~ +85
Maximum System Voltage (IEC)	VDC	1500
Maximum Series Fuse Rating	A	30
Nominal Module Operating Temperature	°C	45 ± 2
Temperature Coefficient	Isc	%/°C 0.045
	Voc	%/°C -0.25
	Pmax	%/°C -0.3

Qualification Test

Thermal Cycling Test	- 40°C to 85°C for 200 cycles
Damp Heat Test	85°C and 85% relative humidity for 1000 hr
Mechanical Load Test	5400Pa (Front) / 2400Pa (Rear)
PID Test	1500 VDC, 96h, 85% RH, 85°C
Hail Impact Test	25mm hail at 23 m/s from 1m distance

Cyclone tested by Structural Engineering Consultants Australia (SECA) Pty Ltd - certificate available on request

Safety factor of *static load test: 1.5 (Test load = Design load x Safety factor)
NexTracker installation : Front load 1800 Pa / Back Load 1800 Pa

Safety Ratings & Warranties

Safety Application Class	Class II
Fire Safety Classification	Class C
Certifications	IEC 61215 , IEC 61730
Warranty	25 years limited product warranty
Performance Guarantee	25 years limited warranty 87.4% power

Electrical Characteristics

108HC Cell Module	Walara-440G4P		
ITEM	UNIT	STC*	NMOT**
Max. Power (Pmax)	Wp	440	335.3
Max. Power Voltage (Vmp)	V	33.36	31.45
Max. Power Current (Imp)	A	13.19	10.66
Open Circuit Voltage (Voc)	V	39.99	38.01
Short Circuit Current (Isc)	A	13.90	11.20
Module Efficiency	%	22.6	
Positive Power Tolerance	W	0 ~ + 5	

*STC (Standard Test Condition): 1,000 W/m² , AM 1.5, 25°C

**NMOT(Nominal Module Operating Temperature) : Irradiance at 800W/m, Ambient Temperature 20°C, Wind Speed 1m/s, air mass of AM1.5

Tolerance of Measuring Pmax, Voc & Isc ± 3% within each watt class at STC

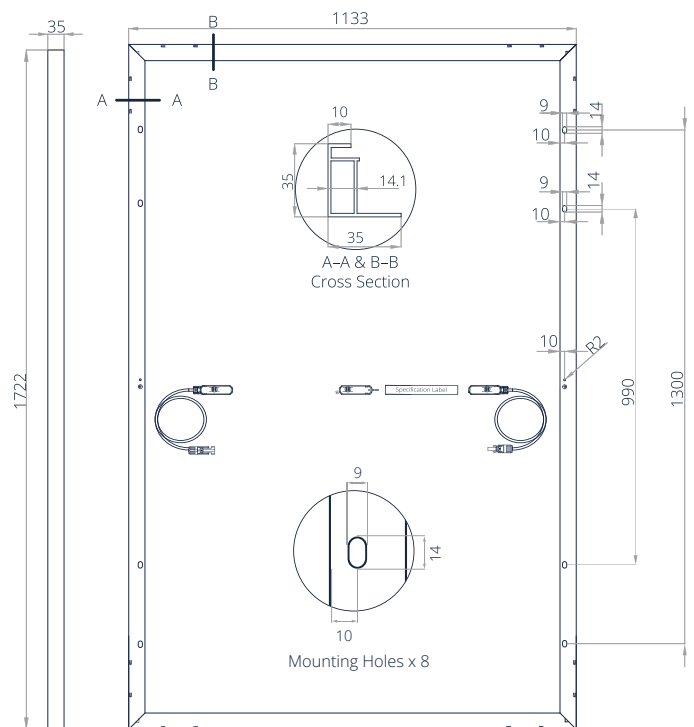

Packaging

Stacking Method	Horizontal	Vertical (Optional)
Panels per Pallet	30	31
Loading Capacity (40HQ)	600	806

Note: • The specifications included in this datasheet are subject to change without notice.
• The electrical data given here is for reference purpose only.
• Manufactured in Australia by Tindo Operations Co Pty Ltd