

IQ Battery 5P Anchor Clip

Quick Install Guide

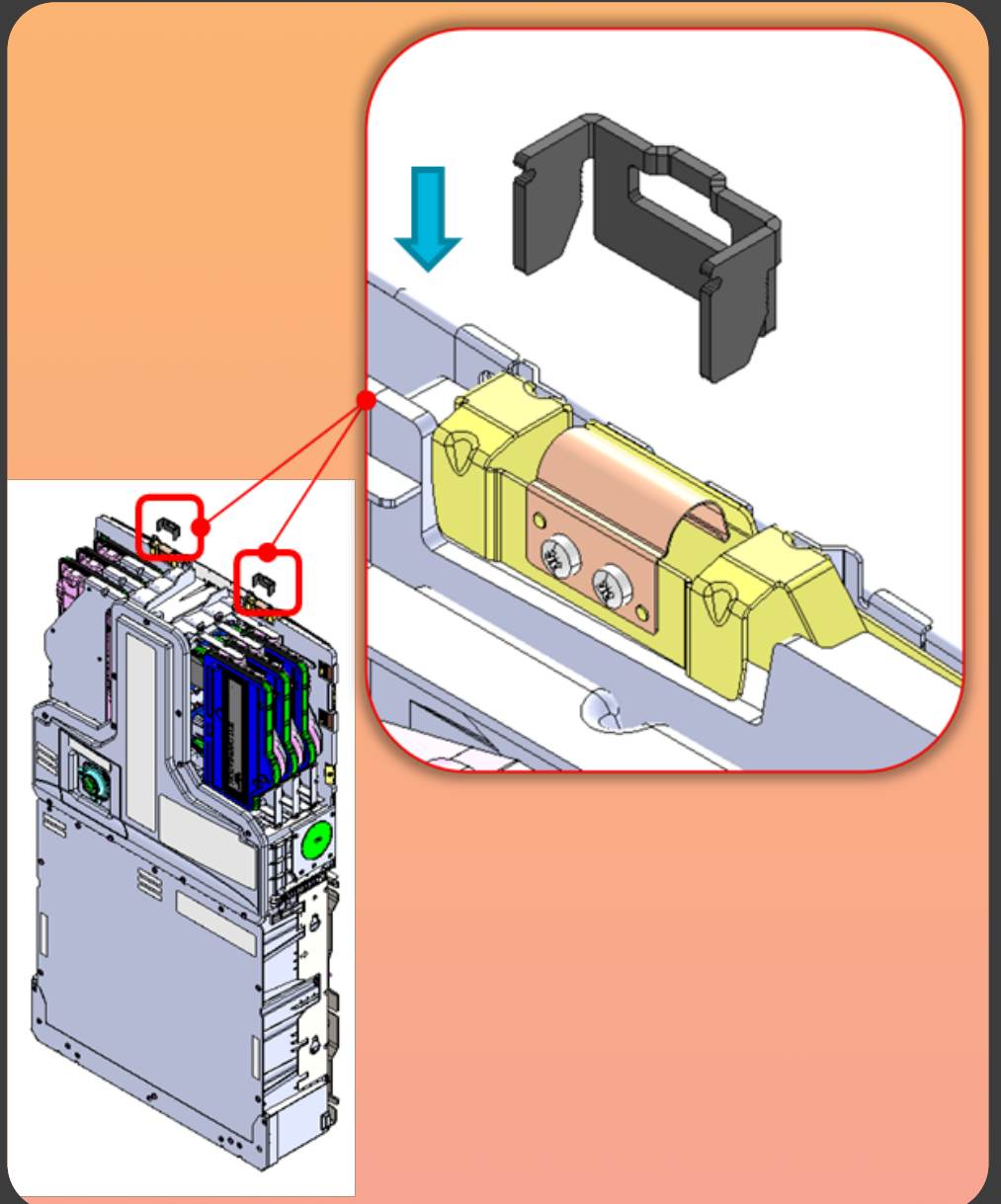

MODEL
B05-CLIP-094-0

VERSION 2.0
JUNE 2023



This document explains to the qualified Enphase installer how to install Anchor Clip on the IQ Battery 5P. This Quick Installation Guide (QIG) shall be referred to, along with the IQ Battery 5P product QIG. This QIG takes precedence over section A of the IQ Battery 5P QIG. Refer to IQ Battery 5P QIG only when explicitly mentioned. Follow IQ Battery 5P QIG for the remaining installation procedure and warning instructions. Read and follow all safety warnings and instructions in the IQ Battery 5P QIG for actual product installation.

The Anchor Clip is installed to prevent forced wobbling of the top portion of IQ Battery 5P when installed on a wall. The package includes two wall side clips and two unit side clips. Refer to the next section for a detailed list of contents.

Table of contents

What's in the box

Tools/additional items required

Installing Anchor Clip

Installation of drill template

Drilling mounting holes in the wall

Installing bottom mounting bracket

Installing Top shield

Installation of Anchor Clip

Safety

What's in the box

LH Wall side clip

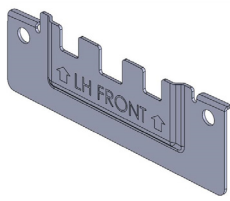

RH Wall side clip

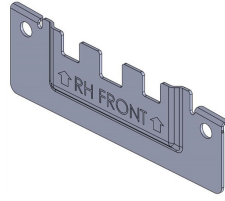

Unit side clip

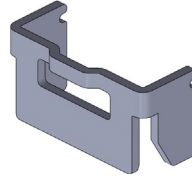

Quick Install Guide- IQ Battery 5P Anchor Clip installation

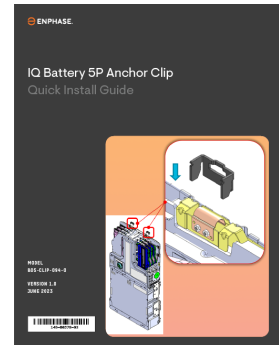

M4 Metal tapping screws, 25 mm



M4 Nylon sleeves, 30 mm



Required only for concrete/
masonry walls

IQ Battery 5P Top shield peel-off label

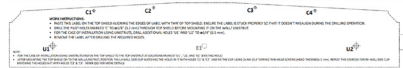

IQ Battery 5P drill template

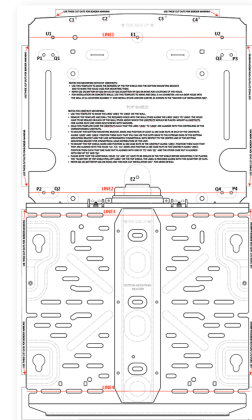

The second drill template is required only in case of unistrut mounting

DESCRIPTION	QUANTITY
LH Wall side clip	1
RH Wall side clip	1
Unit side clip	2
M4 Metal tapping screws, 25 mm	4
M4 Nylon sleeves, 30 mm	4
IQ Battery 5P Top shield peel-off label	1
IQ Battery 5P drill template	2
Quick Install Guide- IQ Battery 5P, Anchor Clip installation	1

Tools/additional items required

S. NO	ITEM NAME	QUANTITY	REMARKS
1	Unistruts	A/R	Depends on the site
2	M8 cage nuts	A/R	For bottom mounting bracket assembly on unistruts
3	M6 cage nuts	A/R	For Top shield assembly on unistruts
4	M10 screws	A/R	For unistrut mounting
5	Washers	A/R	For unistrut mounting
6	Drill	1	
7	Flat-head screwdriver	1	
8	Wrench	1	
9	Socket wrench	1	
10	Torque wrench	1	
11	Level	1	
12	Stud finder	1	
13	Protective gloves for protection against sharp edges	2 pairs	

Installing Anchor Clip

For already installed IQ Battery 5P, uninstall the IQ Battery 5P from the mounting bracket and follow the instructions mentioned herein.

1 Installation of drill template

Stick the “IQ Battery 5P Top shield peel-off label” on the Top shield aligning its edges with that of the Top shield. Ensure the label is stuck properly so that it does not misalign during the drilling operation. Drill the pilot holes marked ‘C’ to $\Phi 1/8"$ (3.2 mm) through the Top shield before mounting it on the wall or unistrut.

In case of installation using unistrut, drill additional holes ‘U1’ and ‘U2’ to $\Phi 1/4"$ (6.5 mm). Ensure the Top shield is secured properly, and no damage is caused during drilling. Peel off the label post drilling

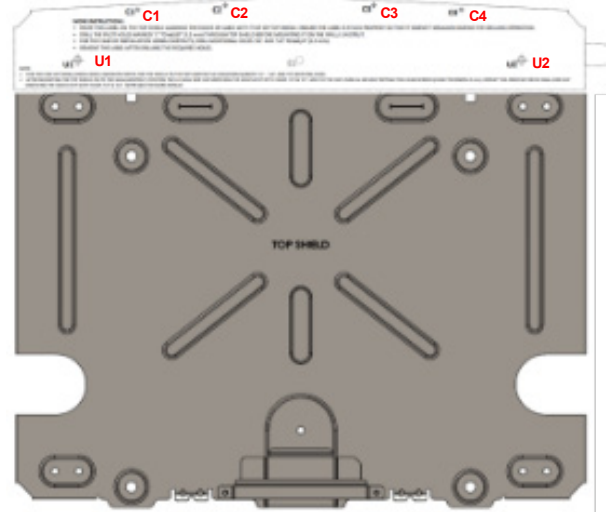

2 Drilling mounting holes in the wall

For the ease of marking all the required drilling points, a dedicated drill template is provided along with the packaging. Depending on the type of installation wall, choose the instructions stated below.

a) For stud mounting (wooden walls)

Position the drill template provided in the package on the wall.

Mark the boundary of the bottom mounting bracket and the Top shield using the template as highlighted in green.

For the bottom mounting bracket, select and mark suitable slots based on the wall mounting configuration mentioned in “Section A” of the IQ Battery 5P QIG. Ensure to use the minimum recommended screws/lag bolts as per IQ Battery 5P QIG.

For Top shield, mark six locations named ‘E’ and ‘P’ or ‘Q’ for drilling.

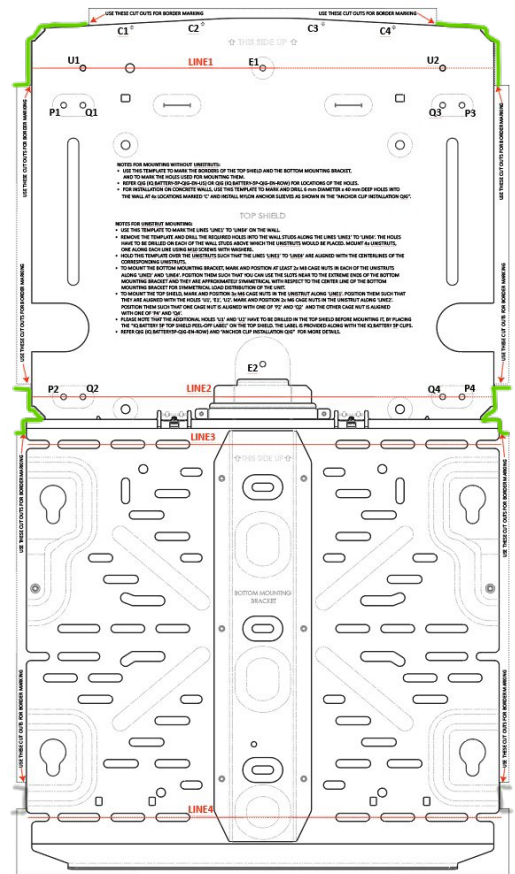

b) For concrete/masonry walls

Position the drill template on the wall.

Mark the boundary of the bottom mounting bracket and the Top shield using the template as highlighted in green.

For bottom mounting bracket, select and mark suitable slots based on the wall mounting configuration mentioned in the “Section A” of IQ Battery 5P QIG. Ensure to use the minimum recommended screws/lag bolts as per IQ Battery 5P QIG.

For the Top shield, mark 10 locations named ‘C’, ‘E’, and ‘P’ or ‘Q’ for drilling. Drill Φ 6 mm*40 mm deep holes in the wall at four locations marked ‘C’ and install nylon anchor sleeve as shown in the illustration.

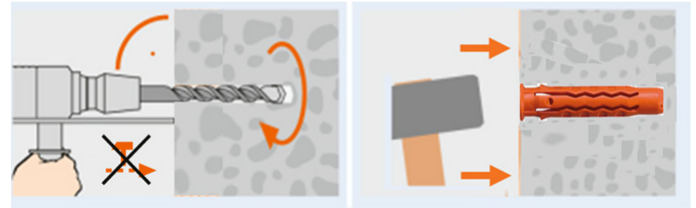

c) For unistrut mounting

Position the drill template on the wall and mark lines ‘LINE1’ to ‘LINE4’. Remove the template and drill the required holes into the wall studs along the lines ‘LINE1’ to ‘LINE4’. The holes must be drilled on each of the wall studs above which the unistruts would be placed. Mount four unistruts, one along each line using M10 screws with washers.

After drilling again, hold this template over the unistruts such that lines ‘LINE1’ to ‘LINE4’ are aligned with the centerlines of the corresponding unistruts.

To mount the bottom mounting bracket, mark and position at least two M8 cage nuts in each of the unistruts along ‘LINE3’ and ‘LINE4’. Position them such that you maintain approximate symmetry about the center line of the bottom mounting bracket for symmetrical load distribution of the unit.

To mount the Top shield, mark and position three M6 cage nuts in the unistrut along ‘LINE1’. Position them such that they are aligned with the holes ‘U1’, ‘E1’, and ‘U2’. Mark and position two M6 cage nuts in the unistrut along ‘LINE2’. Position them such that one cage nut is aligned with either ‘P2’ or ‘Q2’ and the other cage nut is aligned with either ‘P4’ or ‘Q4’.

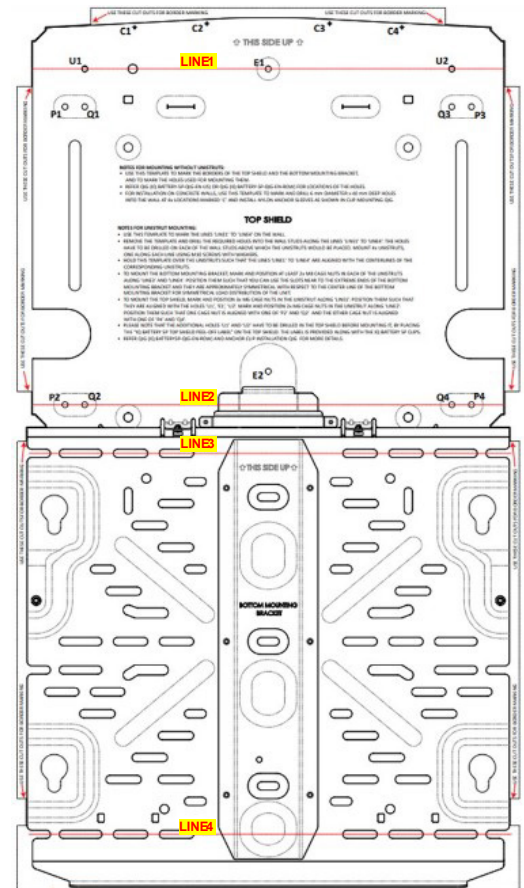

3 Installing the bottom mounting bracket

Position the bottom mounting bracket on the marked positions on the wall/unistruts and fasten it using M8 screws/lag bolts (or masonry attachments for masonry wall) following the manufacturer's recommended torque value.

4 Installing Top shield

Align the Top shield first with the marked border, six hole locations, and then with the grounding tabs of the bottom mounting bracket. Adjust the Top shield grounding tab angle, if required.

Partially tighten the two M4 grounding screws and install the Top shield to the wall with six screws at the already marked locations from the drill template. Finally, fully tighten the grounding screws (torque to 1.5 N m).

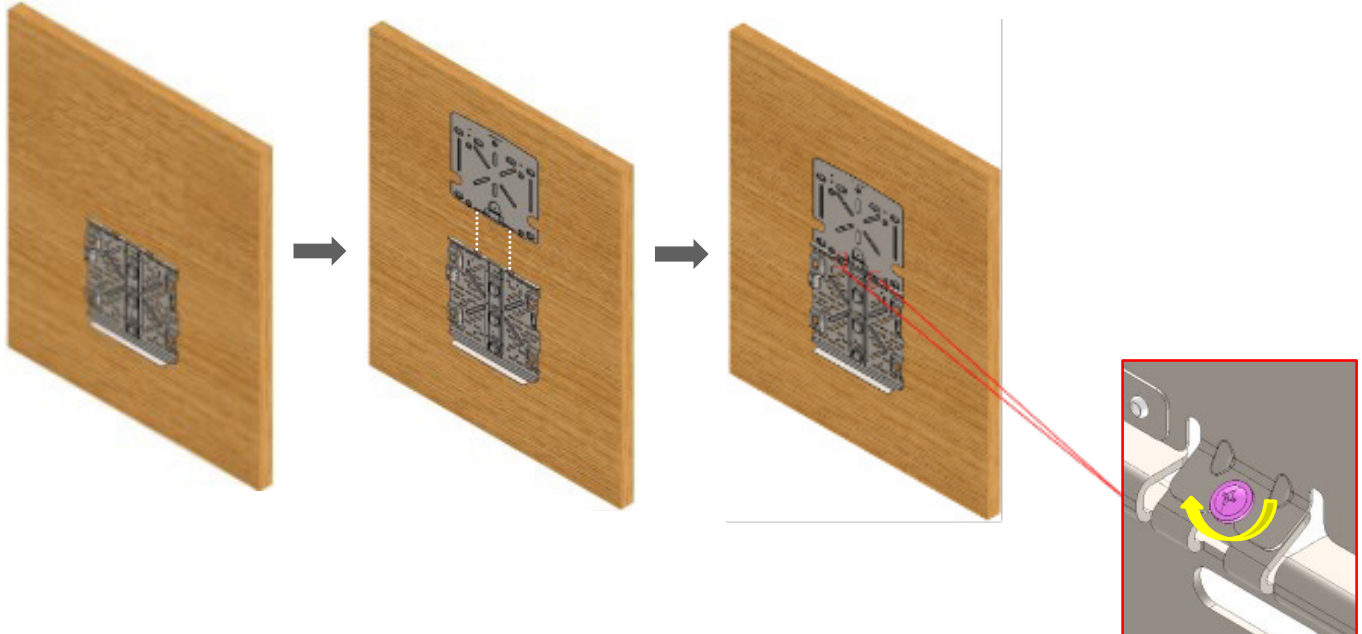

5 Installation of Anchor Clip

- a. Use four M4 Metal tapping screws (provided in the packaging) to fix wall side clips:
 - To the wall through the Top shield in case of mounting on wooden studs or concrete/masonry wall.
 - To the Top shield in case of unistrut mounting
- b. Install the IQ Battery 5P and complete the installation as per section B and section C of IQ Battery 5P QIG.
- c. Push against the wiring cover and hold the IQ Battery 5P top section as close to the wall as possible.

 Warning! Do not push from PCUs to avoid any damage.

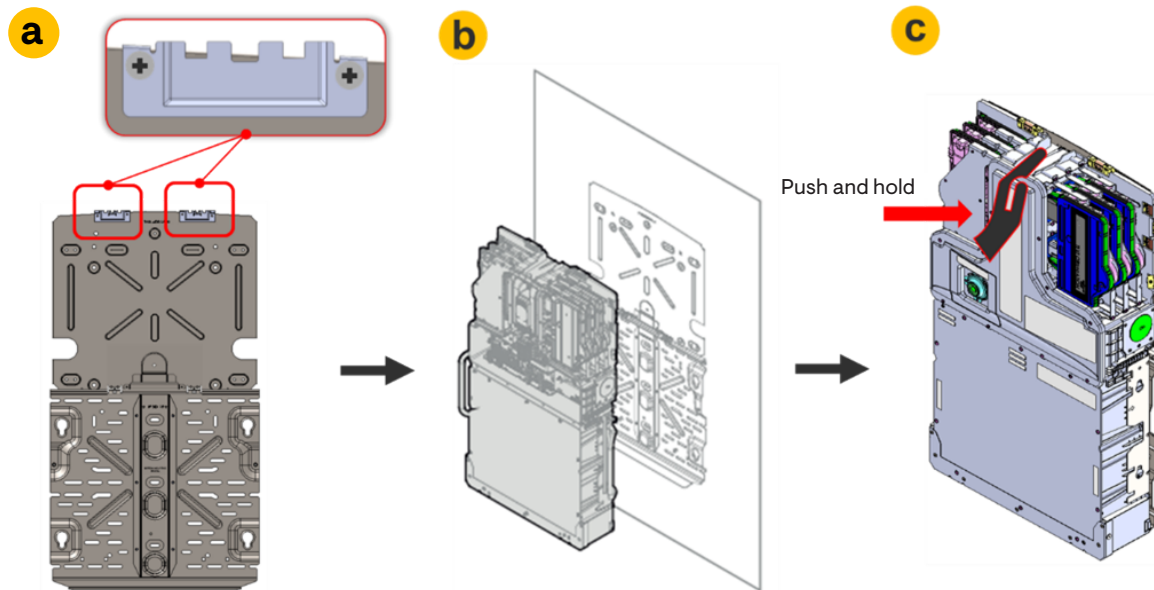

 Note! The part colours shown here are only for distinction. Actual part colours may vary.

- d. Install two unit side clips as shown below to secure the top section of the IQ Battery 5P unit to the wall clip. Slide the unit side clip downwards until the top surface of the clip (orange surface) coincides with the top surface of the IQ Battery 5P unit back plate extension (blue surface). This ensures no obstructions during the IQ Battery 5P cover installation.

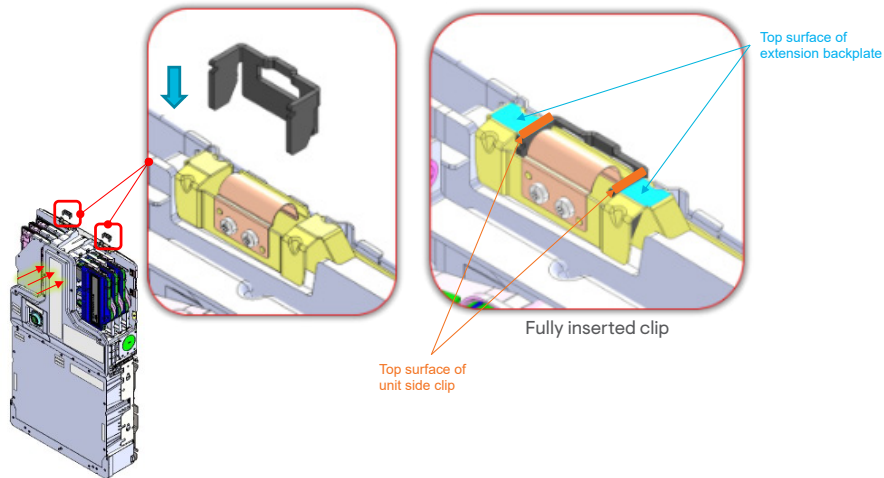

⚠ Note! The part colours shown here are only for distinction. Actual part colours may vary.

- e. Follow Section D onwards from IQ Battery 5P QIG to complete the installation.

Disengaging Anchor Clip

⚠ Warning! Ensure not to touch or damage the EMI metal gaskets while removing the clips. EMI metal gaskets are delicate and need to be handled carefully.

Disengaging of the unit side clip can be done by lifting it up using a flat-head screwdriver or nose plier. Installers need to carefully insert the tool at the back slot as shown below and pull the clip upwards.

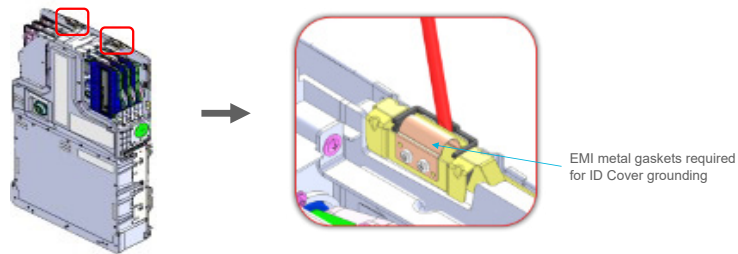

⚠ Note! The part colours shown here are only for distinction. Actual part colours may vary. Alternatively, unit side clips can also be lifted by using the front slots on either side of the clip using a flat-head screwdriver.

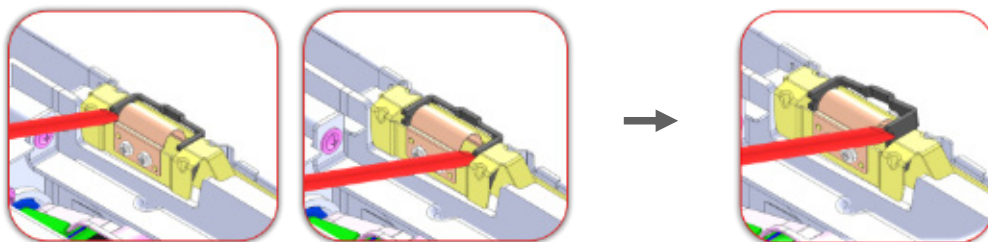

⚠ Note! The part colours shown here are only for distinction. Actual part colours may vary.

Safety

IMPORTANT SAFETY INSTRUCTIONS. SAVE THESE INSTRUCTIONS.

This guide contains important instructions that you must follow during the installation and maintenance of the Enphase IQ Battery(ies).

Failing to follow any of these instructions may void the warranty (enphase.com/warranty).

Refer to material safety datasheet document and safety datasheet at enphase.com/en-au.

In Case of Fire or Other Emergency

In all cases:

- If safe to do so, switch off the AC breaker for the IQ Battery 5P circuit, and if an isolator switch is present, switch off the AC isolator for the IQ Battery 5P circuit.
- Contact the fire department or other required emergency response team.
- Evacuate the area.
- Contact Enphase customer support at <https://enphase.com/contact/support>

In case of fire:

- When safe, use a fire extinguisher. Suitable types are A, B, and C dry chemical fire extinguishers. Additional extinguishing media include carbon dioxide or alcohol-resistant foams.

In case of flooding:

- Stay out of the water if any part of the IQ Battery(ies) or wiring is submerged.
- If possible, protect the system by finding and stopping the source of the water, and pumping it away.
- If water has contacted the battery, call your installer to arrange an inspection. If you are sure that water has never contacted the battery, let the area dry completely before use.

In case of unusual noise, smell, or smoke:

- Ensure nothing is in contact with the IQ Battery(ies) or in the venting area of the IQ Battery(ies).
- Ventilate the room.

In case of electrolyte exposure:

The Enphase IQ Battery 5P has a lithium iron phosphate (LFP) battery that contains organic electrolyte and is sealed in a protective case. Leaked electrolyte is toxic and highly flammable. Leaked electrolyte is colorless and has a sweet odor. Electrolyte fluid tends to evaporate quickly, leaving behind a white grainy substance. If an odor is obvious, proceed to the following steps:

DANGER: DO NOT TOUCH OR INGEST ANY LIQUID SUSPECTED TO BE BATTERY ELECTROLYTE.

- Evacuate personnel to a safe area and keep unauthorized personnel away.
- Isolate the spill area to a minimum distance of 75 feet (25 m).
- Eliminate all ignition sources (no smoking, sparks, flames, or hot equipment) in the immediate area around the spill.
- Do not touch or walk through spilled material.
- Avoid breathing vapors. Ensure adequate ventilation.
- Use personal protective equipment.
- Contact Enphase customer support at <https://enphase.com/contact/support> or 1 (800) 006-374

Safety and Advisory Symbols

 **DANGER:** This indicates a hazardous situation, which if not avoided, will result in death or serious injury.

 **WARNING:** This indicates a situation where failure to follow instructions may be a safety hazard or cause equipment malfunction. Use extreme caution and follow instructions carefully.

 **NOTE:** This indicates information particularly important for optimal system operation. Follow instructions carefully.

Safety Instructions

 **DANGER:** Risk of electric shock. Risk of fire. Only qualified electricians should install, troubleshoot, or replace the IQ Battery(ies).

 **DANGER:** Risk of fire or explosion. Only qualified personnel, using personal protective equipment (PPE), should transport or handle the IQ Battery(ies).

 **DANGER:** Risk of explosion. Do not dispose of IQ Battery(ies) in a fire or by burning. The IQ Battery(ies) can explode.

 **DANGER:** Risk of fire or explosion. This product is designed for stationary installation only and should be used accordingly. It is not designed for mobile applications such as installation on vehicles and trailers and should not be used in such applications.

 **DANGER:** Risk of fire. During use, when stored, or during transport, keep the IQ Battery(ies) in an area that is well-ventilated and protected from the elements, where the ambient temperature and humidity are within -20° C to 55° C (-4° F to 131° F) and 5% to 95% RH, non-condensing, preferably out of direct sunlight. Do not install the IQ Battery(ies) at elevations over 2000 m (6561 ft) above sea level.

 **DANGER:** Risk of fire. If the IQ Battery(ies) generate smoke, remove AC power from the Enphase System and turn the DC control switch to the off position so that charging/discharging stops.

 **DANGER:** Risk of electric shock. Do not use Enphase equipment in a manner not specified by the manufacturer. Doing so may cause death or injury to persons or damage to equipment.

 **DANGER:** Risk of electric shock. Do not install the IQ Battery(ies) without first removing AC power from the photovoltaic system. Disconnect the power coming from the photovoltaics before servicing or installing.

 **DANGER:** Risk of electric shock. Always de-energize the AC branch circuit during an emergency and/or before servicing the IQ Battery(ies).

 **DANGER:** Risk of electric shock. Risk of high short-circuit current. Observe the following precautions when working on batteries:

- Remove watches, rings, or other metal objects.
- Use tools with insulated handles.
- Wear insulating gloves and boots.
- Do not lay tools or metal parts on top of batteries.

 **DANGER:** Risk of electric shock. Risk of fire. Do not work alone. Someone should be in the range of your voice or close enough to come to your aid when you work with or near electrical equipment.

 **DANGER:** Risk of fire. Do not allow or place flammable, sparking, or explosive items near the IQ Battery(ies).





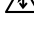







 **DANGER:** Risk of electric shock. In areas where flooding is possible, install the IQ Battery(ies) at a height that prevents water ingress.







 **DANGER:** Risk of electric shock. AC voltage is present at the output when the DC switch is on.

 **DANGER:** Risk of electric shock. Branch circuit protection must be off before switching DC power on or off.

 **DANGER:** Risk of electric shock. The DC switch must be in the OFF position for shipping and service.

 **WARNING:** Risks of electric shock, energy hazard, and chemical hazard. Do not disassemble.

-  **WARNING:** Risk of equipment damage. During use, storage, transport, or installation, always keep the IQ Battery(ies) in an upright position.
-  **WARNING:** You must install the IQ Battery(ies) only on a suitable wall using an Enphase wall-mount bracket.
-  **WARNING:** Before installing or using the IQ Battery(ies), read all instructions and cautionary markings in this guide and on the equipment.
-  **WARNING:** Do not install or use the IQ Battery(ies) if it has been damaged in any way.
-  **WARNING:** Do not exceed the maximum number (1) of IQ Batteries in a 20 A AC branch circuit.
-  **WARNING:** Do not sit on, step on, place objects on, or insert objects into the IQ Battery(ies).
-  **WARNING:** Do not place beverages or liquid containers on top of the IQ Battery(ies). Do not expose the IQ Battery(ies) to liquids or flooding.
-  **WARNING:** When placing the IQ Battery(ies) in storage, ensure to follow the shutdown procedure and confirm that AC power is not present and that the DC switch is in the OFF position. While in storage, damage to the battery can occur from over-discharge. If the battery state of charge falls to 0%, the IQ Battery(ies) can be damaged or destroyed. Because of this, the IQ Battery(ies) must only be stored for a limited amount of time.
 - The IQ Battery(ies) must be installed and energized by the “Must Energize By” date on the shipping box label.
 - The IQ Battery(ies) must have a charge state of no more than 30% when placed in storage. To do this, the IQ Battery(ies) must be placed in Sleep Mode.
 - If the IQ Battery(ies) is already been installed, it must be placed into Sleep Mode prior to uninstalling. A battery in Sleep Mode can be stored for a maximum of two months after being placed into Sleep Mode.
-  **NOTE:** Perform installation and wiring, including protection against lightning and resulting voltage surge, in accordance with all applicable local electrical codes and standards.
-  **NOTE:** Using unapproved attachments or accessories could result in damage or injury.
-  **NOTE:** Install properly rated overcurrent protection as part of the system installation.
-  **NOTE:** To ensure optimal reliability and to meet warranty requirements, the IQ Battery(ies) must be installed and/or stored according to the instructions in this guide.

-  **NOTE:** The Enphase IQ Battery(ies) are intended to operate with an internet connection. Failure to maintain an internet connection may have an impact on the warranty. See Limited Warranty for full terms and services (enphase.com/warranty).
-  **NOTE:** When replacing Enphase IQ Battery(ies), you must replace it with an IQ Battery(ies) of the same type, with the same AC current rating.
-  **NOTE:** When disconnected and stored, no automatic charge of the battery is possible.
-  **NOTE:** Properly mount the IQ Battery(ies). Ensure that the mounting location is structurally suited to bearing the weight of the IQ Battery(ies).
-  **NOTE:** During use, storage, and transport, keep the IQ Battery(ies):
 - Properly ventilated
 - Away from water, other liquids, heat, sparks, and direct sunlight
 - Away from excessive dust, corrosive and explosive gases like ammonia, and oil smoke
 - Away from direct exposure to gas exhaust, such as from motor vehicles
 - Free of vibrations
 - Away from falling or moving objects, including motor vehicles. If mounted in the path of a motor vehicle, we recommend a 91 cm (36 in) minimum mounting height
 - At an elevation of lower than 2,000 m (6,561 ft) above sea-level
 - In a location compliant with fire safety regulations
 - In a location compliant with local building codes and standards
-  **NOTE:** Conditions for the IQ Battery 5P installation site apply also to storage conditions.

Manufacturer:
 Enphase Energy Inc.,
 47281 Bayside Pkwy.,
 Fremont, CA, 94538,
 The United States of America
 PH: +1 707-763-4784
 Assembled in China

Importer:
 Enphase Energy Aust.
 Pty/Ltd., 88 Market St.,
 South Melbourne VIC 3205.
 PH: +61 3 86691679



Environmental Protection

ELECTRONIC DEVICE: DO NOT THROW AWAY. Waste electrical products should not be disposed of with household waste.

Proper disposal of batteries is required. Refer to your local codes for disposal requirements.

Enphase customer support: <https://enphase.com/contact/support>

Revision history

REVISION	DATE	DESCRIPTION
140-00323-02	June 2023	Editorial updates
140-00323-01	June 2023	Initial release

Installer notes

Installer notes

© 2023 Enphase Energy. All rights reserved. Enphase, the e and CC logos, IQ, and certain other marks listed at <https://enphase.com/trademark-usage-guidelines> are trademarks of Enphase Energy, Inc. in the US and other countries. Data subject to change.

